

Angular Contact Ball Bearings

Brass cage angular contact ball bearing- 7321 BECBP

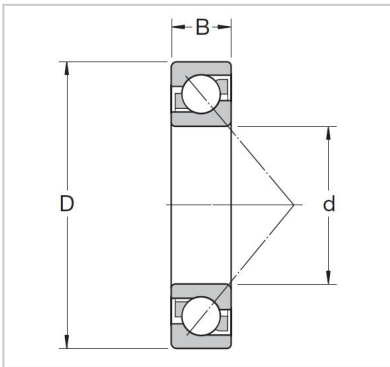

Abutment and fillet dimensions

Db max.	7321 BECBP
Da max.	-
da min.	105
rb max.	225
ra max.	49

Dimensions

a	216
r3,4 min.	208
r1,2 min	6.95
D1	3 800
d2	3 800
d1	8.55

Mass

KG	151
----	-----

Speed ratings r/min

Limiting speed	127
Reference speed	182

Fatigue load limit

Pu kN	3
-------	----------

Basic load ratings KN

dynamic C kN	1.1
static Co kN	94

Basic design bearing

B mm	119
D mm	211
d mm	218
Basic design bearing	2.5

Designations

Universally matchable bearing	1
-------------------------------	----------